

## Sockets for RLS Relays

### ZRLS1 NA

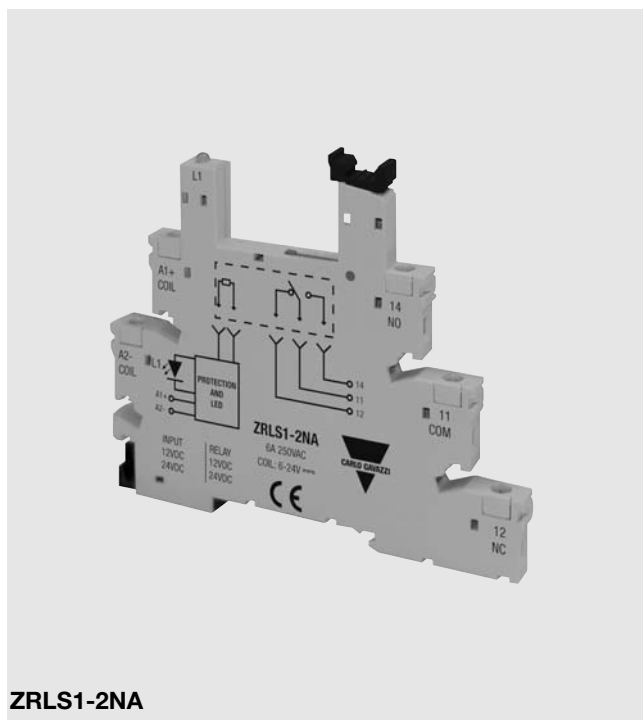

ZRLS1-2NA

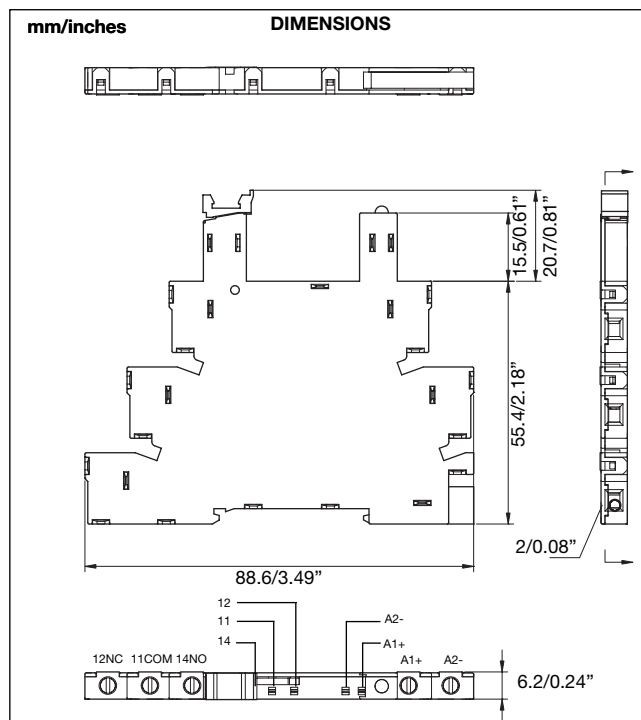

### General data

Rated voltage	300VAC
Rated current	6A
Insulation voltage	>3kV
Protection degree	IP 20 B
Socket material	PA66+GF (V0)
Socket colour	RAL 7035 / Pantone 1C
Contacts material	CuSn 6.5-0.1
Contacts surface	tin-plated
Operating temp.	-40° to +70°C (-40° to 158°F)
Terminal type	Screw cage
Max Wire section	
Flex / compact wire	2 x 2.5mm <sup>2</sup> (14AWG)
Cable End	2 x 1.5mm <sup>2</sup> (16AWG)

### Output data

Max voltage	300VAC max
Max current	6A

### Input data and Ordering code

ZRLS1-2NA	
Input	from 6 to 24VDC
Coil rate*	from 6 to 24VDC
ZRLS1-3NA	
Input	from 6 to 24VAC/VDC
Coil rate*	from 6 to 24VDC
ZRLS1-4NA	
Input	120VAC
Coil rate*	24VDC
ZRLS1-5NA	
Input	230VAC
Coil rate*	24VDC

### Approvals



Box content: 20 sockets	
Box size: (W 15 x D 8.5 x H 9.5) mm	Weight: 600g
(W 0.59 x D 0.33 x H 0.37) inches	Weight: 21.16oz

### Optional Accessories (to be ordered separately if required)

Labels	ZRLS-LAB
Separator	ZRLS-DIV
Bridging bar	ZRLS-BB

\* The coil rate value is the socket output voltage. The relay to be fitted should have the same coil voltage.

## Optional sockets bridging bars

### ZRLS-BB

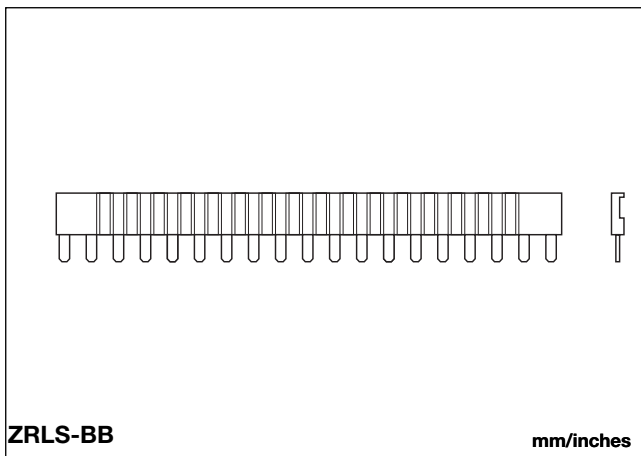

#### General data

Plastic insulator material	PA66 + GF (V0)
Plastic insulator colour	Black
Metal jumper	Tinned copper

#### Packaging

Box content:	1 plastic bag, 10pcs.
Weight:	~50g (~1.76oz)



## Optional labels for ZRLS1-NA and ZRLS1-GA

### ZRLS-LAB

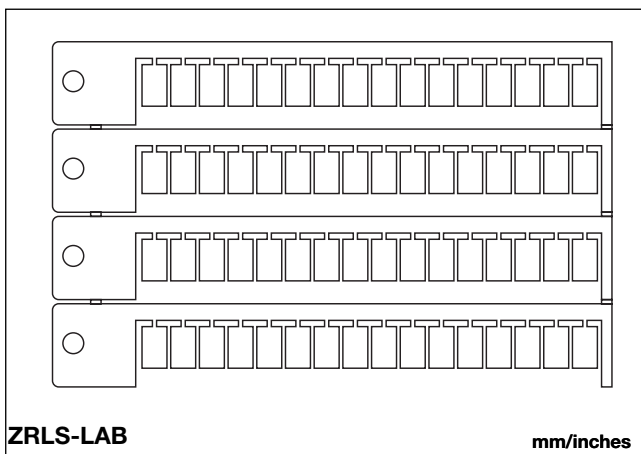

#### General data

Plastic labels material	Polycarbonate (PC)
Plastic labels colour	White

#### Packaging

Box content:	1 plastic bag, 10pcs.
Weight:	~50g (~1.76oz)



## Optional separator for ZRLS1-NA and ZRLS1-GA

### ZRLS-DIV

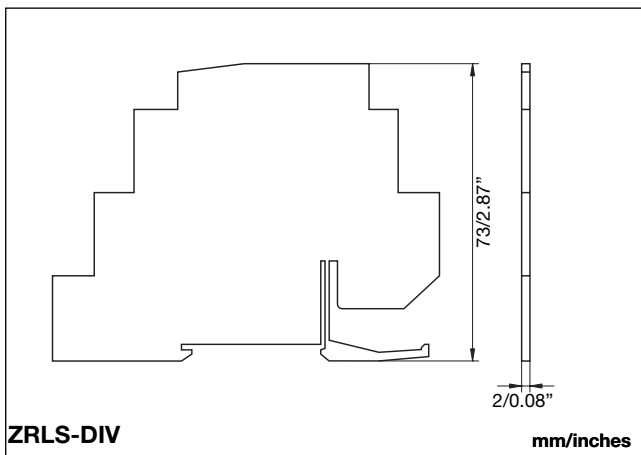

#### General data

Plastic separator material	PA66
Plastic separator colour	RAL 7035 / Pantone 1C

#### Packaging

Box content:	1 plastic bag, 10pcs.
Weight:	~50g (~1.76oz)

