

Solid State Relay



BH4-SSTRI8-230

8-channel receiver with triac output

Module load: 8 x 10 Watt

For mounting on DIN-rail (EN50022)

LED-indications for supply, smart-house carrier and outputs

AC power supply

H4-housing

Address coding by BGT-COD-BAT



MODE OF OPERATION

8-channel receiver with 8 normally open solid state outputs. Each output is coded by means of the code programmer BGT-COD-BAT. For changing the default setting, please refer to the datasheet on BGT-COD-BAT.

The outputs are normally OFF. When a transmitter coded to the selected channel is activated, the output turns ON. When the selected channel is disabled, the output turns off. The default setting is such that upon loss of smart-house bus carrier all the outputs go OFF.

OUTPUT SPECIFICATIONS

Outputs	Triac
Total load	8 x 10 W
Minimum load	5mA/230 VAC
Short circuit protection	NO
Dielectric voltage	
Outputs - smart-house	≥ 4 kVAC (rms)
Response time	≤ 1 pulse train

TYPE SELECTION

Supply	Ordering no
230 VAC	BH4-SSTRI8-230

SUPPLY SPECIFICATIONS

Power supply	Overvoltage cat. III (IEC 60664)
Rated operational voltage through term. 21 & 22	230 VAC, +/- 10% (IEC 60038)
Frequency	45 to 65 Hz
Rated operational power	Typ. 3.0 VA
Power dissipation	≤ 4 W
Rated impulse withstand voltage	4 kV
Dielectric voltage	
Supply - smart-house	≥ 4 kVAC (rms)

Fail polarity state delay	
Upon loss of smart-house carrier	≤ 20 ms

Power ON delay	typ. 2 s.
-----------------------	-----------

Indication for:	
supply ON	LED, green
smart-house carrier	LED, yellow
output ON	LED, red (one per output)

Environment	
Degree of protection	IP20
Pollution degree	3 (IEC 60664)
Operating temperature	-5 to +50°C (+23° to +122°F)
Storage temperature	-50 to +85°C (-58° to +185°F)

Humidity (non-condensing)	20 to 80%
----------------------------------	-----------

Mechanical resistance	
Shock	5 G (11 ms)
Vibration	2 G (6 to 55 Hz)

Housing	H4
----------------	----

Weight	400 g
---------------	-------

DIMENSIONS (mm)

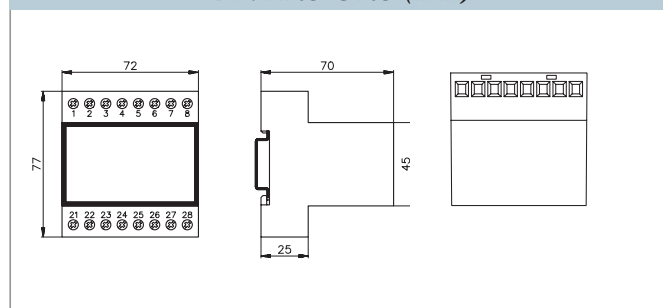

WIRING DIAGRAM

